

The project's main significance is the convergence. With the design inspired by the shape and development of the form of a flower that can be found on the Panke Field, the space aims to establish dialogue: between the simple and the complex, the similar and the different, the rational and the organic forms. Mostly it proposes the dialogue between people. The flower is composed by different nucleos that connect to each other on a focal point.

Following the flower shape, the project creates different activities that communicate and integrate through a centered space. On this area there will be steel sticks that connect to each other by a circular cover, recovering the flower form. Those will have an interactive feature and will spread through the area.

The Panke Platz proposes a space that has as main objective to provide, through the created space, the experience of group connection, exchanging experiences and interaction between people.

Summer University
DesignBuild: Panke-Feld
SS 2016

Fangqi Liu
Gavin Cooper
Larissa Reis

Lina Hakim
Nadia Sufian Asali
Yulia Tselikov

Panke Platz

An Interactive Community Space

Habitat Unit

CoCoon
CONTEXTUAL CONSTRUCTION

in collaboration with:

Bezirksamt
Pankow

berlin Berlin

berlin Berlin
Beauftragte für
Stadtentwicklung
und Umwelt



GANGWAY EV



Kreisverband
Berlin-Mitte e. V.

Concept



Site Plan



SCALE 1:500



Timeline

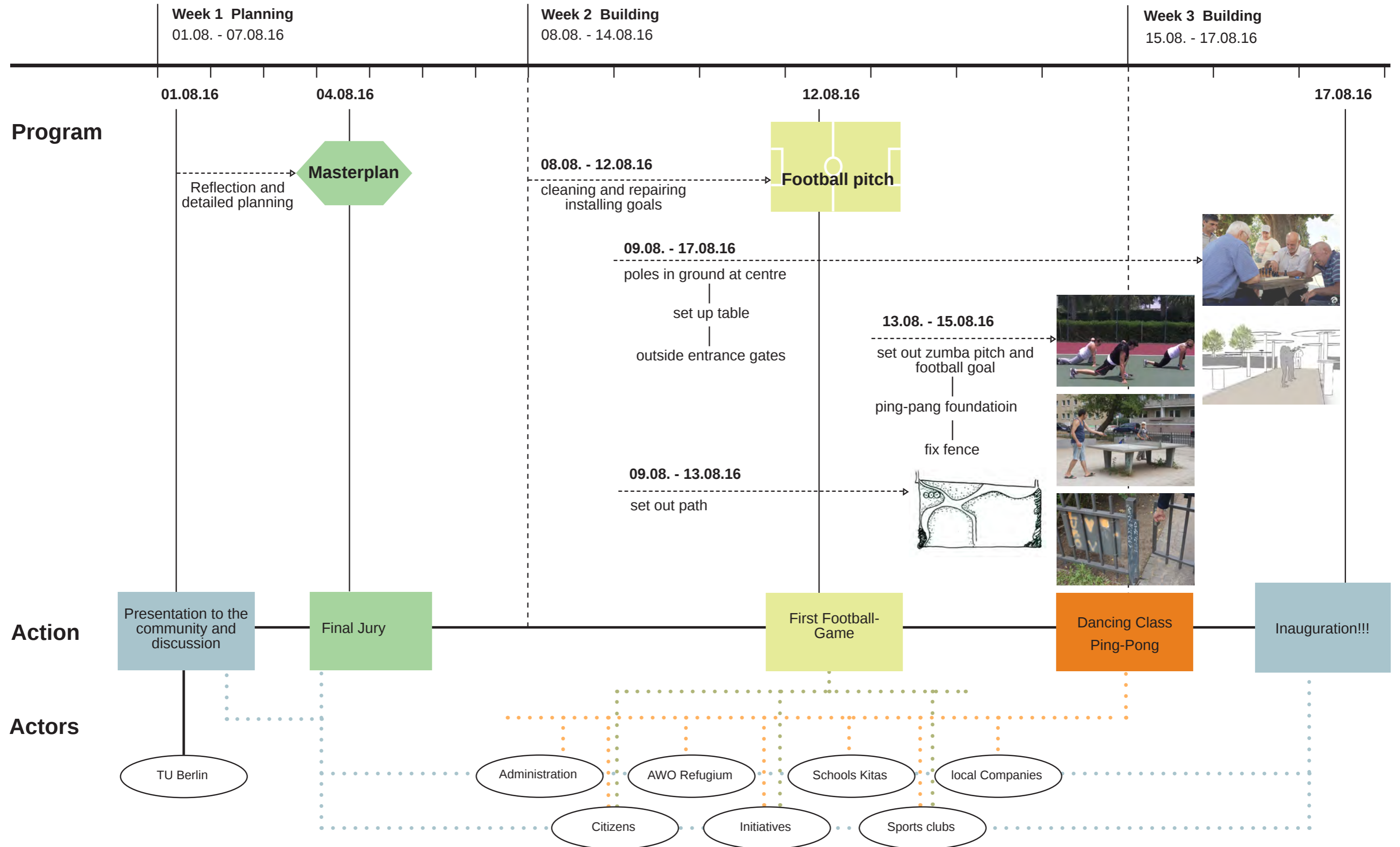

Functional Analysis



Detail Sketch

The space proposes an area where people can meet, interact, create and develop things together. The focal space of the project creates an area that will lounge cultural events, music festivals and public classes. The area is also the connection point to other areas that are part the project: football pitch, dance space, the barbecue space ... The visual identity is through the sticks with covers.

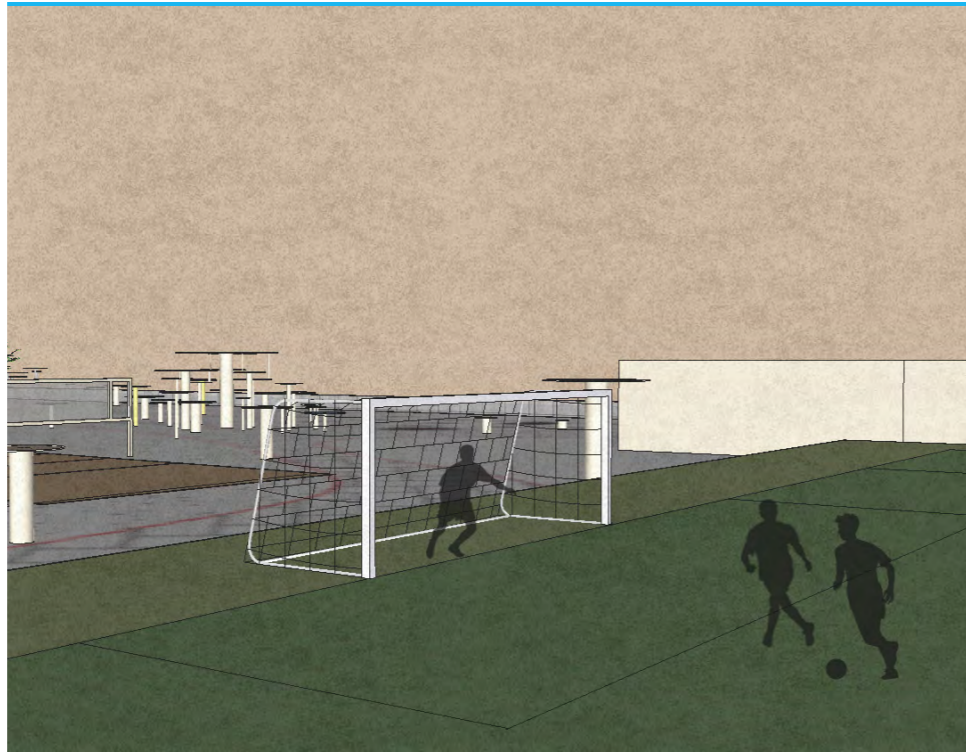

1 Football Pitch



2 Entrance

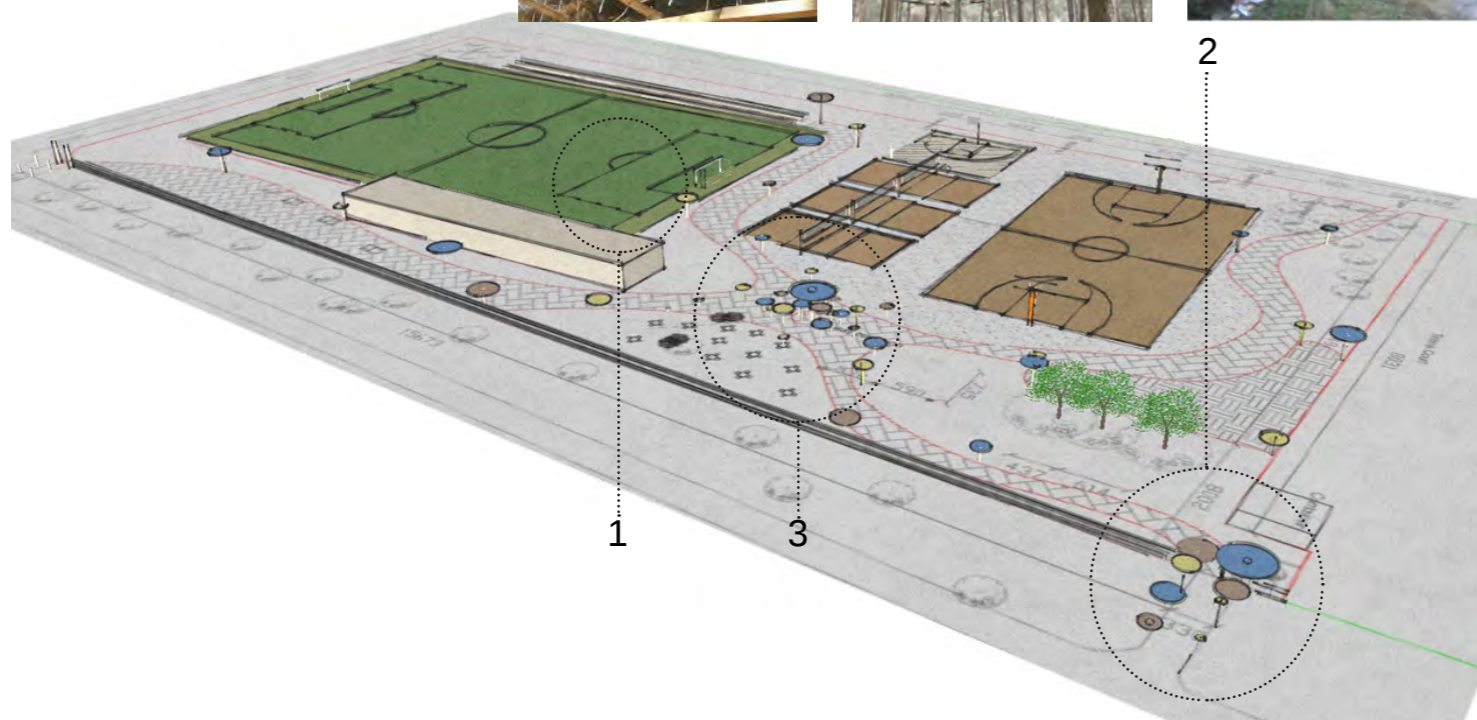

Bird's-eye



3 Central Platz

The Panke Feld aims to bring the civil society together through an attractive communal living approach. A public sportsground is the requested program, along side recreational public facilities that invite different users into the space.

While visiting the Project Site, a main element was of interest: Borders. As the site is surrounded by the pathway along the Panke on one side and a green area on the other sides, our intention was to blurr the boundary with the city.

This border has intermittent visual connections over the fence and in between the existing trees; therefore we decided to strengthen the visual interaction. An indication of the visible moments along the Panke pathway would happen through public amenities that citizens could easily approach (eg. bbq & seating area, outdoor exhibition space, performance area, etc ...)

The concept design confirms the locations of the attractions within the Park, which will provide space for smaller scale programming along the Panke. The venues will be linked by an animated artery, that acts as the core of the Panke Feld.

Summer University
DesignBuild: Panke-Feld
SS 2016

Upasna Saimy
Meghana Hedge
Weiyue Liang

Wilko Schroth
Jason Hage

Panke-Steg

[Re]Creation

Habitat Unit

CoCoon
CONTEXTUAL CONSTRUCTION

in collaboration with:

Bezirksamt
Pankow

be Berlin

be Berlin
Berliner
Entwicklungs-
und
Management-
GmbH



GANGWAY EV



Kreisverband
Berlin-Mitte e. V.

Concept

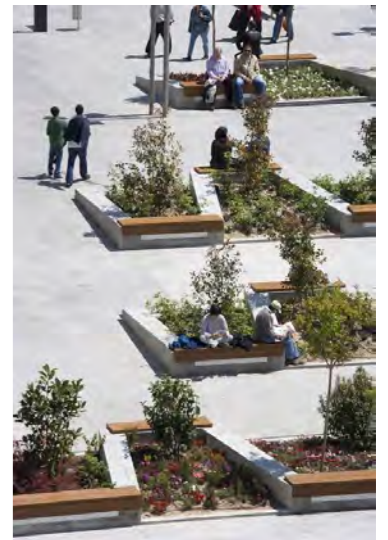
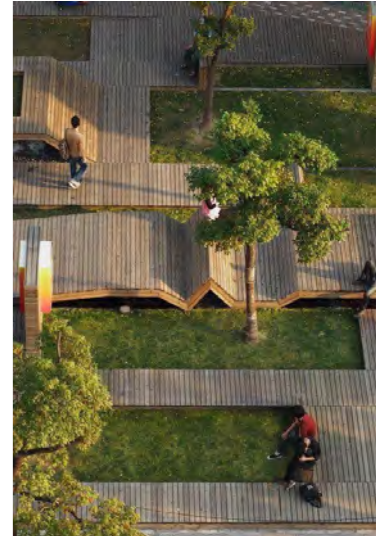
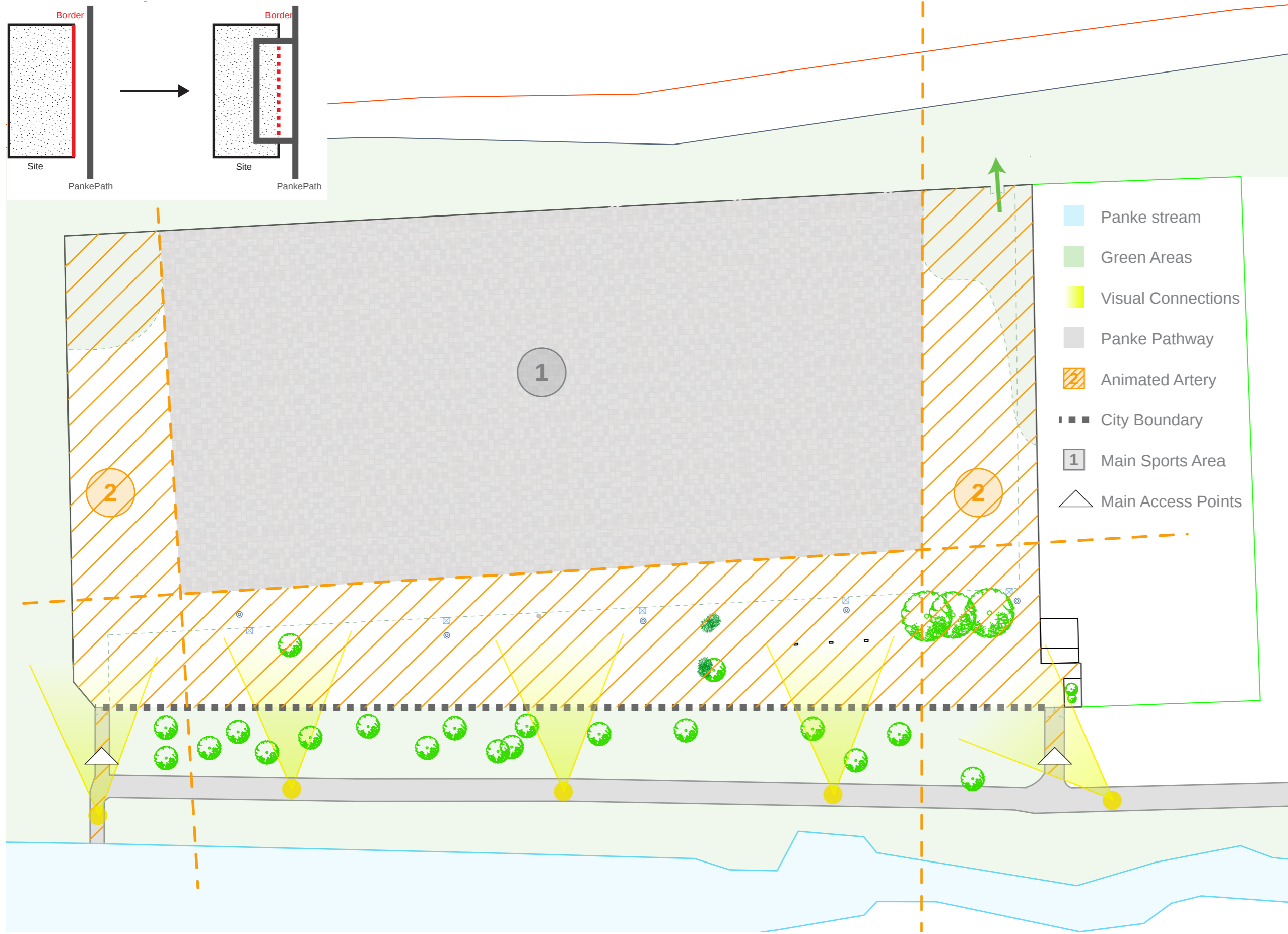

Site Plan

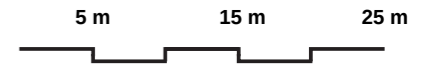

M 1:500



Timeline

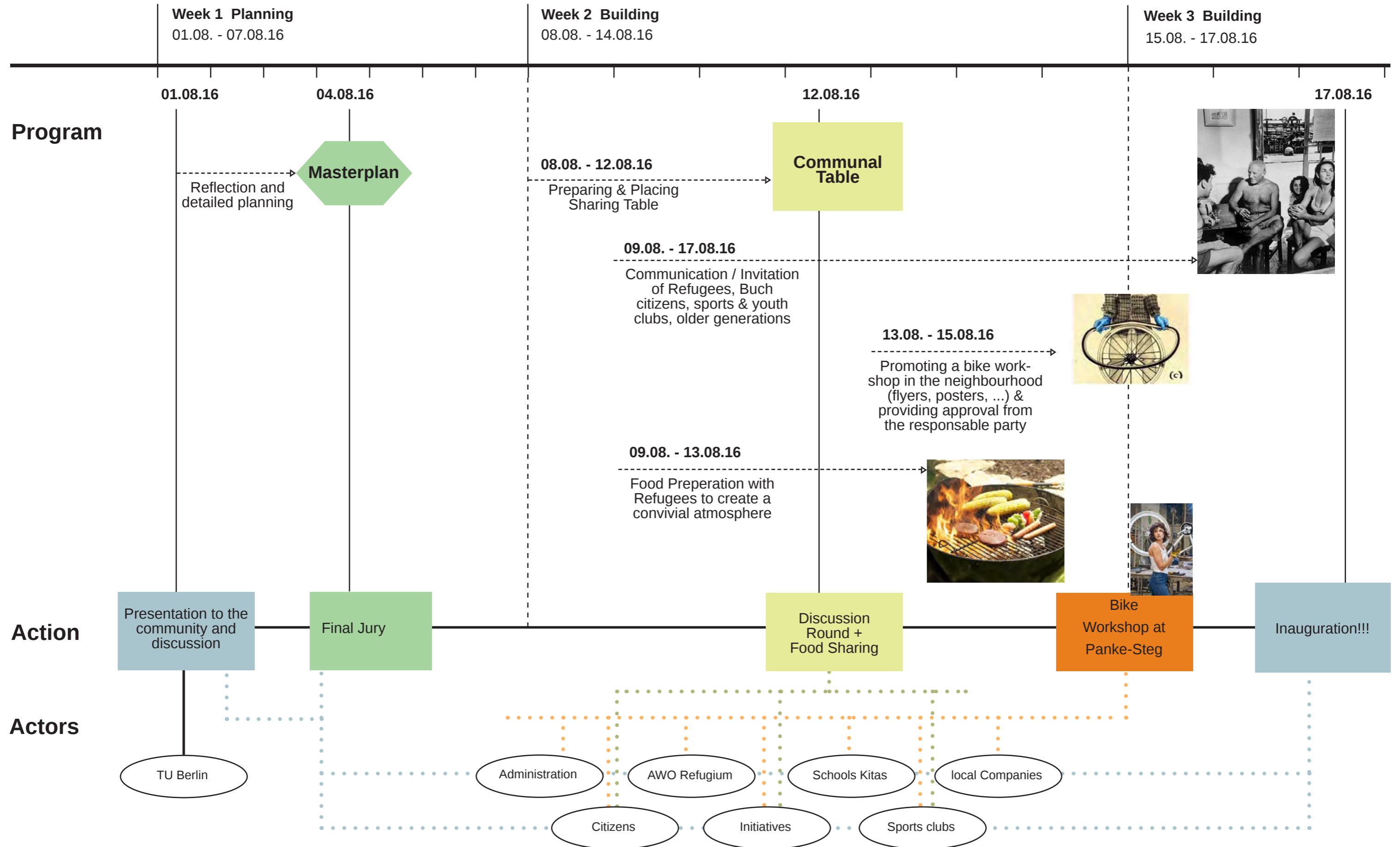

Moments



a. Entrance Area

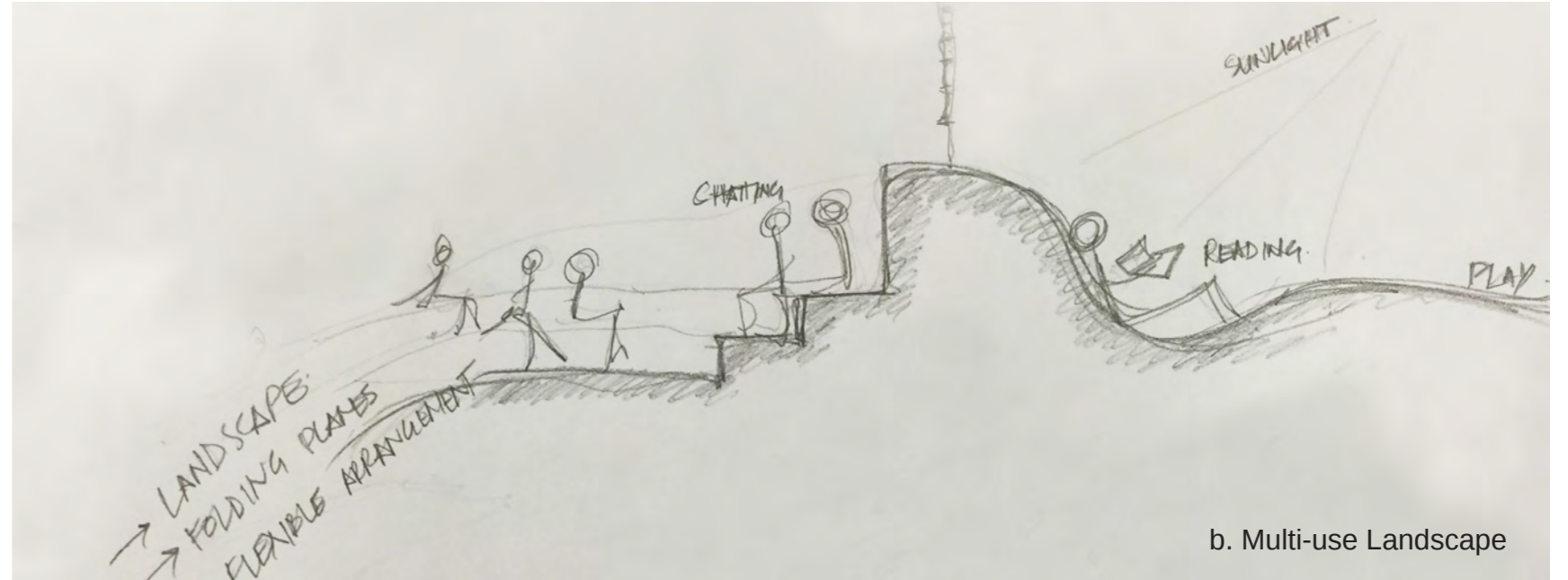

b. Multi-use Landscape

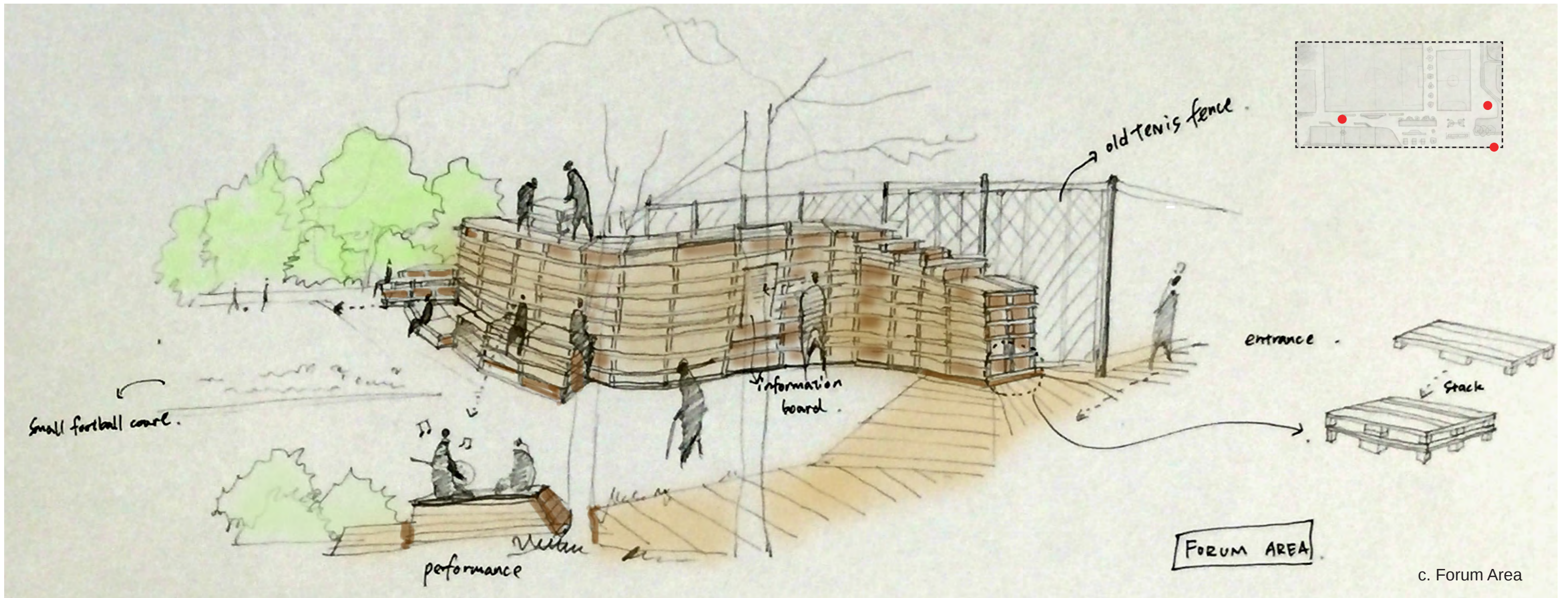

c. Forum Area

Moments

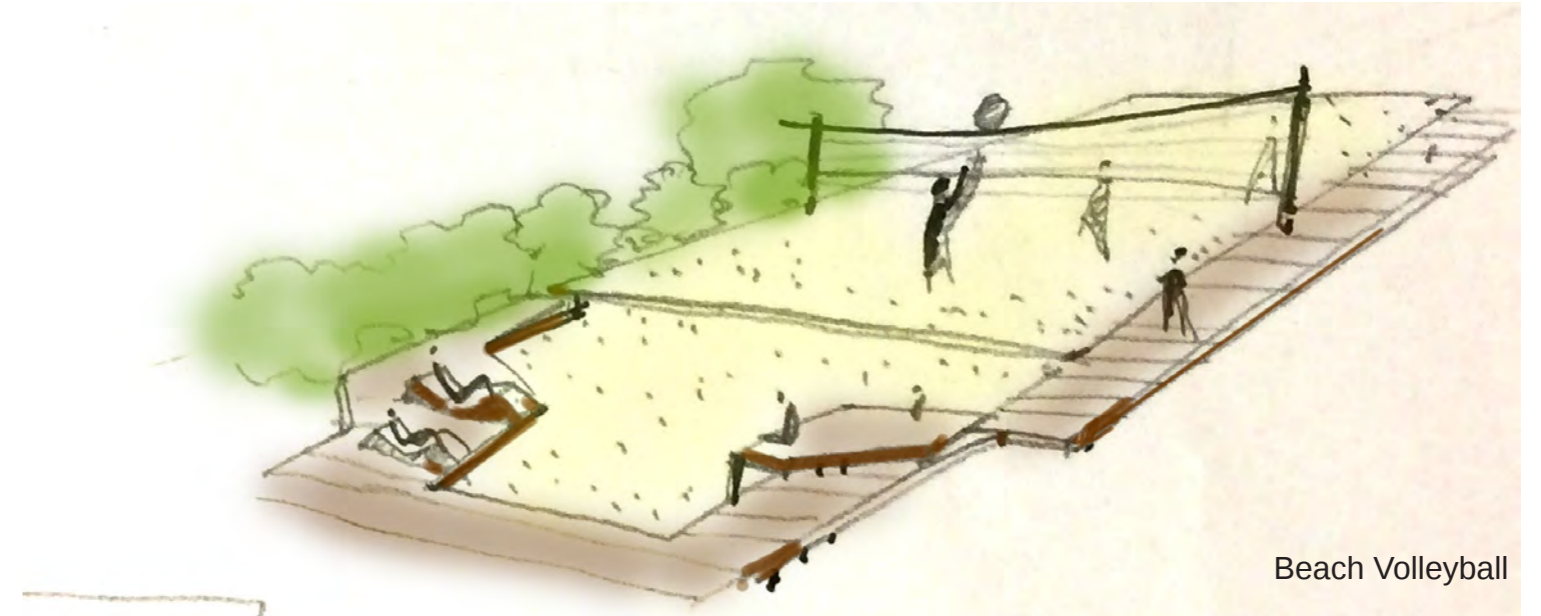

UNDIVIDED:

In recent years, many refugees have found their way to the friendly community that is Buch. In order to smooth their transition into German culture, a community space that both the previous and incoming residents can use must be developed. This space will be Panke-Feld.

UNIMPOSING:

By incorporating elements from Buch, we aim to make everything from Panke-Feld's entrance to its variety of sports fields harmonious with the surrounding area. This will be realised through our block-central motif, our colour theme, and our modular furniture. These elements, particularly the community mural, serve to draw in any passerby who may have never taken note of the previously under-utilised park. The new layout of the park is designed in a way that is spacious and inviting while also providing numerous fields, relaxation and gathering areas.

UNBLOCKED:

Panke-Feld will develop into a community space with minimal maintenance and ever-expanding capabilities. The space will be open to art and language workshops, small market stands, sports training events, and any other activity the community can organise. Whether it be in the barbecue area or on the football pitch, residents will find a place to develop strong relationships and build a stronger community.

Summer University
DesignBuild: Panke-Feld
SS 2016

Ahmad Al Hakeem
Thomas Mannell
Bridget O'Brien

Stephanie Valasek
Karim Youssef Rezk

Buch Unblocked

Habitat Unit

CoCoon
CONTEXTUAL CONSTRUCTION

in collaboration with:

Bezirksamt
Pankow

berlin Berlin

berlin Berlin
Kommunikation
für Migration und
Integration

**BEZIRKSAMT
PANKOW**

**BEZIRKSAMT
MITTE**

GANGWAY EV

AWO

Kreisverband
Berlin-Mitte e. V.

Concept



BUCH: MODULAR, BLOCKS, VIBRANT, COLOUR

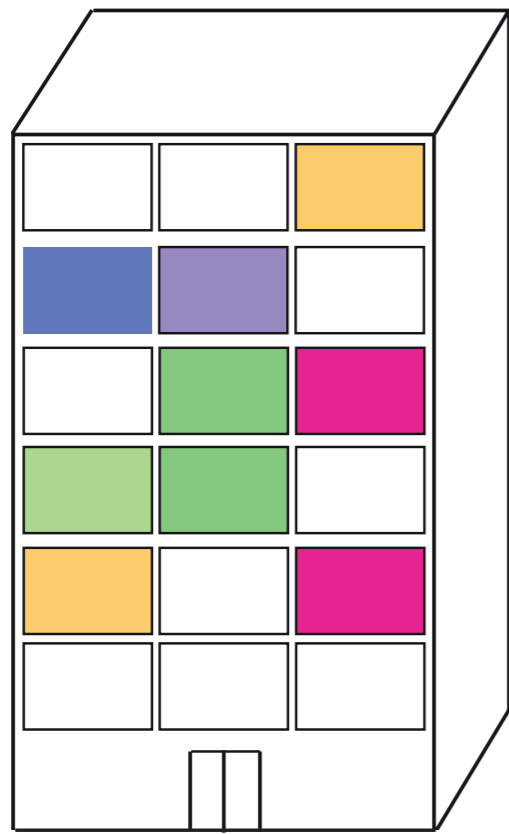

COLOURS & SHAPES OF BUCH

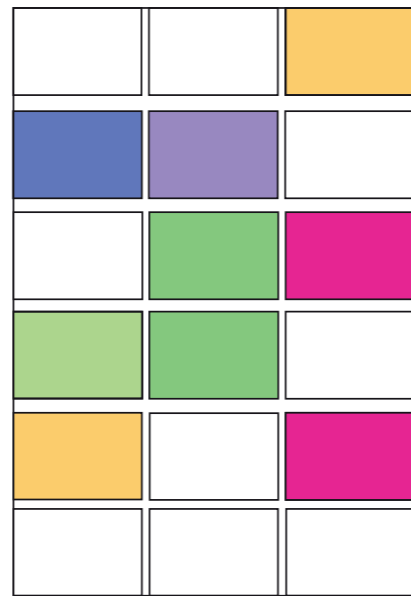

ABSTRACTED GRID,
BLOCKS & COLOUR



GRID OVER THE SITE TO
DETERMINE ZONES &
SPACES

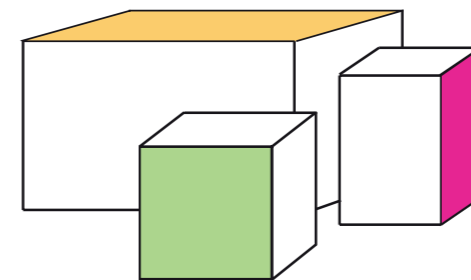

BLOCK AND MODULAR
FEATURES & FURNITURE
FOR FLEXIBLE COMMUNITY
SPACE

Site Plan



5 m 15 m 25 m

SCALE 1:500

92291

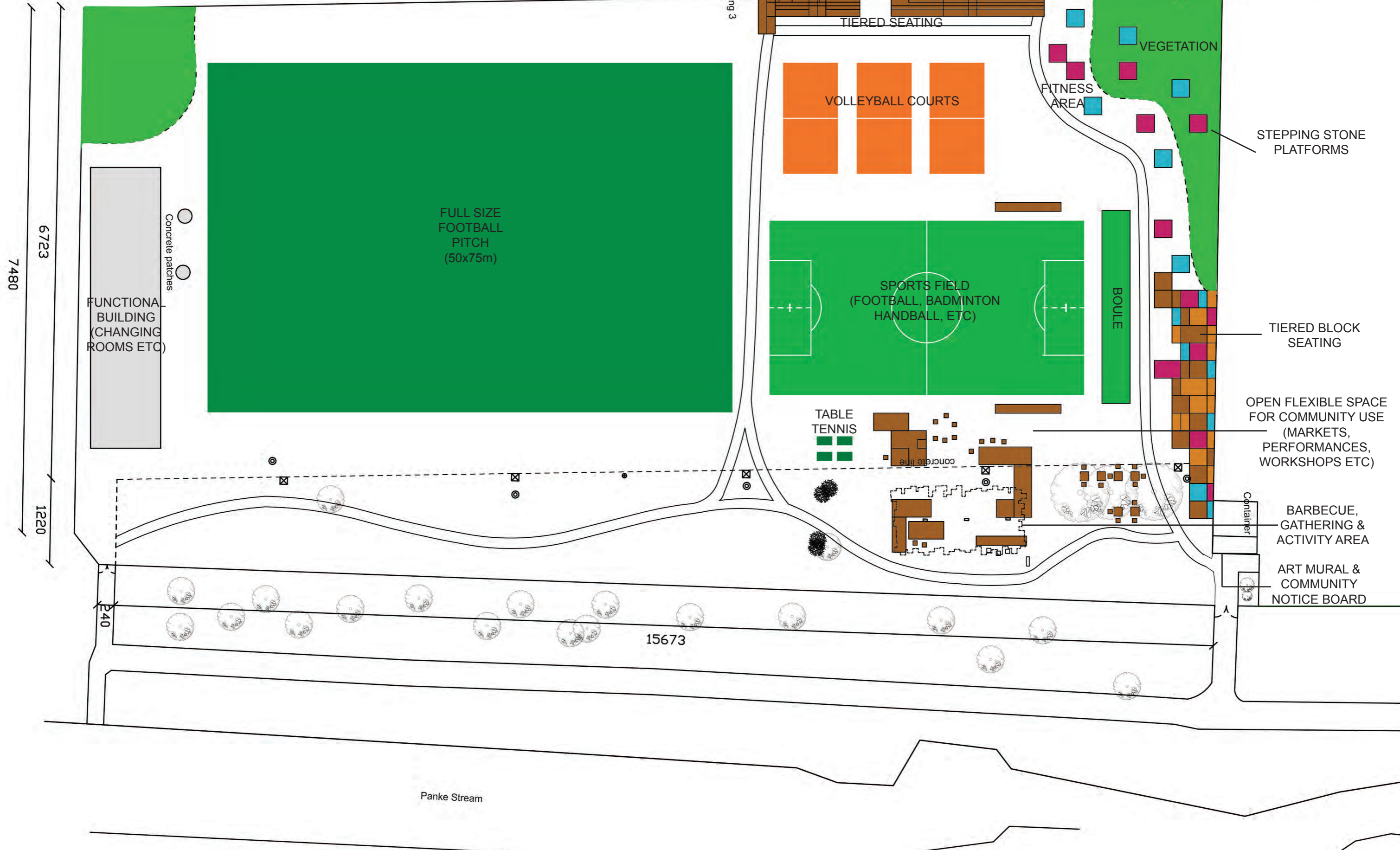

Panke Stream

15673

240

6723

7480

1220

FUNCTIONAL BUILDING (CHANGING ROOMS ETC)

Concrete patches

FULL SIZE FOOTBALL PITCH (50x75m)

TIERED SEATING

VOLLEYBALL COURTS

FITNESS AREA

VEGETATION

STEPPING STONE PLATFORMS

SPORTS FIELD (FOOTBALL, BADMINTON, HANDBALL, ETC)

BOULE

TIERED BLOCK SEATING

OPEN FLEXIBLE SPACE FOR COMMUNITY USE (MARKETS, PERFORMANCES, WORKSHOPS ETC)

TABLE TENNIS

BARBECUE, GATHERING & ACTIVITY AREA

ART MURAL & COMMUNITY NOTICE BOARD

Container

Opening 3

Gate

Timeline

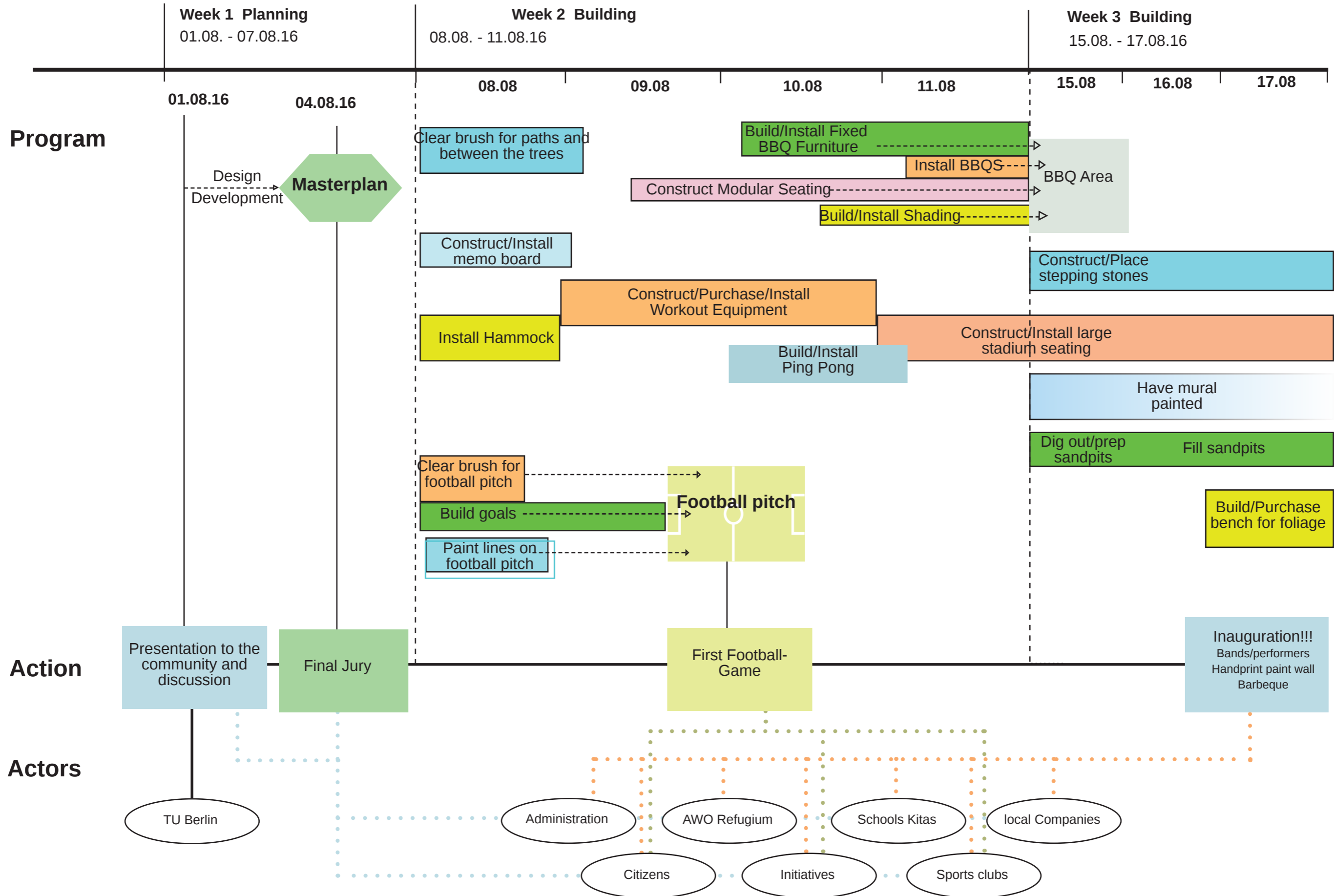

PLAN

SCALE: 1:250

Gate

VEGETATION

STEPPING STONE PLATFORMS

FITNESS AREA

BOULE

TIERED BLOCK SEATING

ART MURAL & COMMUNITY NOTICE BOARD

OPEN FLEXIBLE SPACE FOR COMMUNITY USE (MARKETS, PERFORMANCES, WORKSHOPS ETC)

MULTI- USE SPORTS FIELD (FOOTBALL, BADMINTON, HANDBALL, ETC)

BARBECUE, GATHERING & ACTIVITY AREA

TIERED SEATING

VOLLEYBALL

VOLLEYBALL

VOLLEYBALL

TABLE TENNIS

SPORTS, FITNESS & ACTIVITY ZONES

COMMUNITY GATHERING SPACE

FLEXIBLE USE FOR COMMUNITY EVENTS AND ACTIVITIES SUCH AS MARKETS, MUSIC & DANCE EVENTS, ART, WORKSHOPS ETC



**MODULAR AND BLOCK ELEMENTS;
FLEXIBLE USE OF SPACE, DETERMINED BY THE USERS**



BARBECUE, SEATING AND MULTI- PURPOSE COMMUNITY GATHERING SPACE;
SHADING, BLOCK TABLES, SEATING AND FLEXIBLE PLATFORMS



MULTI- FUNCTION GATHERING SPACES ARE PROVIDED BOTH UNDER
SHELTER AND IN THE OPEN. MODULAR TABLES, BENCHES, SEATS AND
PLATFORMS CAN BE USED AND MOVED AROUND AS THE USER DESIRES.

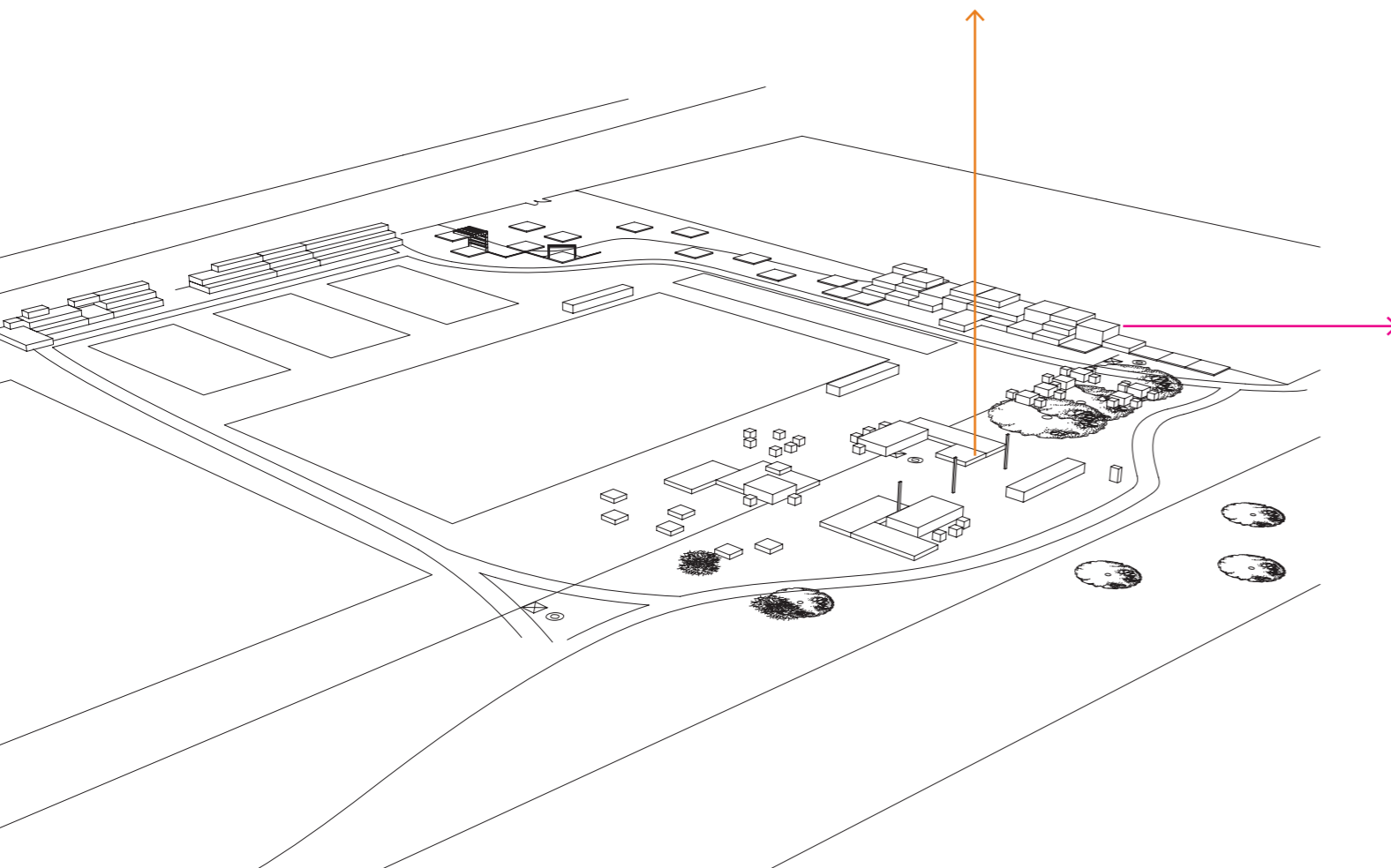

- USAGE PROPOSALS:
- BARBECUE AND EATING
 - CASUAL SEATING
 - LANGUAGE & CONVERSATION CLASSES
 - ART & CRAFT CLASSES
 - WORKSHOPS

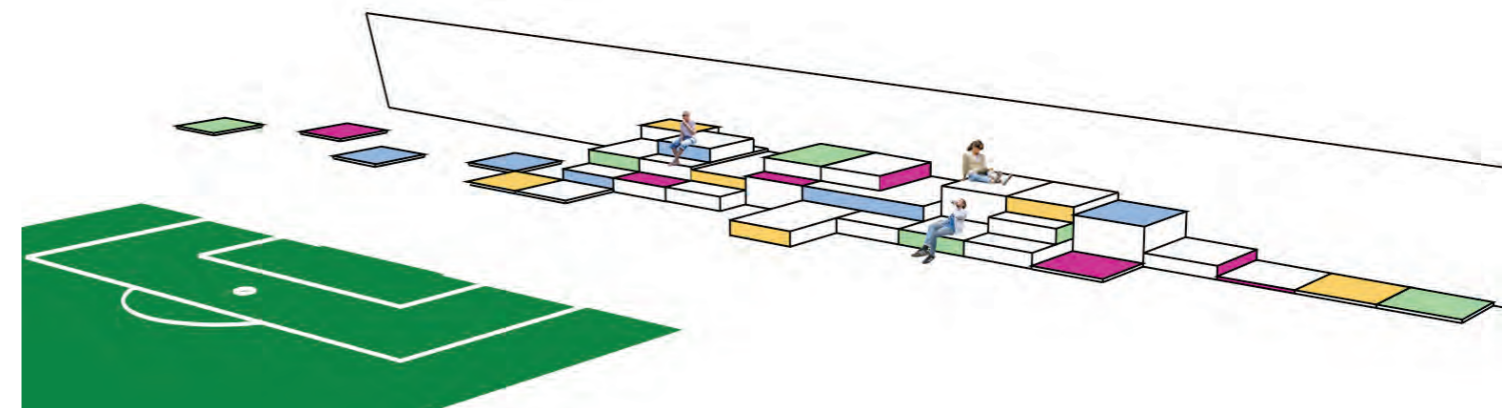

TIERED PLATFORM SEATING AND STEPPING STONES

TIERED PLATFORM SEATING IS PROVIDED AS SPECTATOR
SEATING FOR SPORTS AND POTENTIAL MUSIC, DANCE AND
OTHER PERFORMANCES, AS WELL AS A CASUAL SEATING
AND GATHERING SPACE.

Acknowledging that we are in the preliminary stages of the long term development of the Panke Field, we considered how we can enable potential visitors to the field to be active within its physical evolution. This is an attempt to extend the design process beyond the point of our delivery, allowing the users influence in future design decisions, whilst facilitating them as actors within this design process.

Our team also focused on using sport as medium for exchange between new and old residents. We experimented with rethinking adapted to harness greater exchange between disparate communities who previously have not interacted. We did this through deconstructing the commonly found rules of a 2 sided game of football to include more teams and modify the rules. After considering the existing rules of football we felt that the dualism often found within games would not be good for cultural and communal exchange with this context. We believe our adaptations of the existing rules will allow more opportunity for exchange and interaction within a game that is a new and enjoyable experience for all participants.

Summer University
DesignBuild: Panke-Feld
SS 2016

Hongkyu Jang
Joe Mckenzie
Isabella Castelli

Julio Villalta
Bassel Asfari

ex-Change Platform

Extending the design process

Habitat Unit

CoCoon
CONTEXTUAL CONSTRUCTION

in collaboration with:

Bezirksamt
Pankow

be Berlin

be Berlin
Berliner
Entwicklungs
und
Management
GmbH



GANGWAY EV



Kreisverband
Berlin-Mitte e. V.

Concept

Buch

Community exchange

Flexibility and adaptability

'Flying Carpets'

Communication

Extended and inclusive
design process



Site Plan

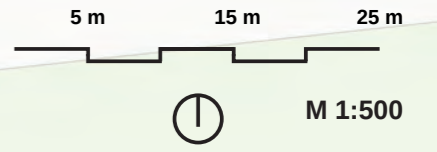

Timeline

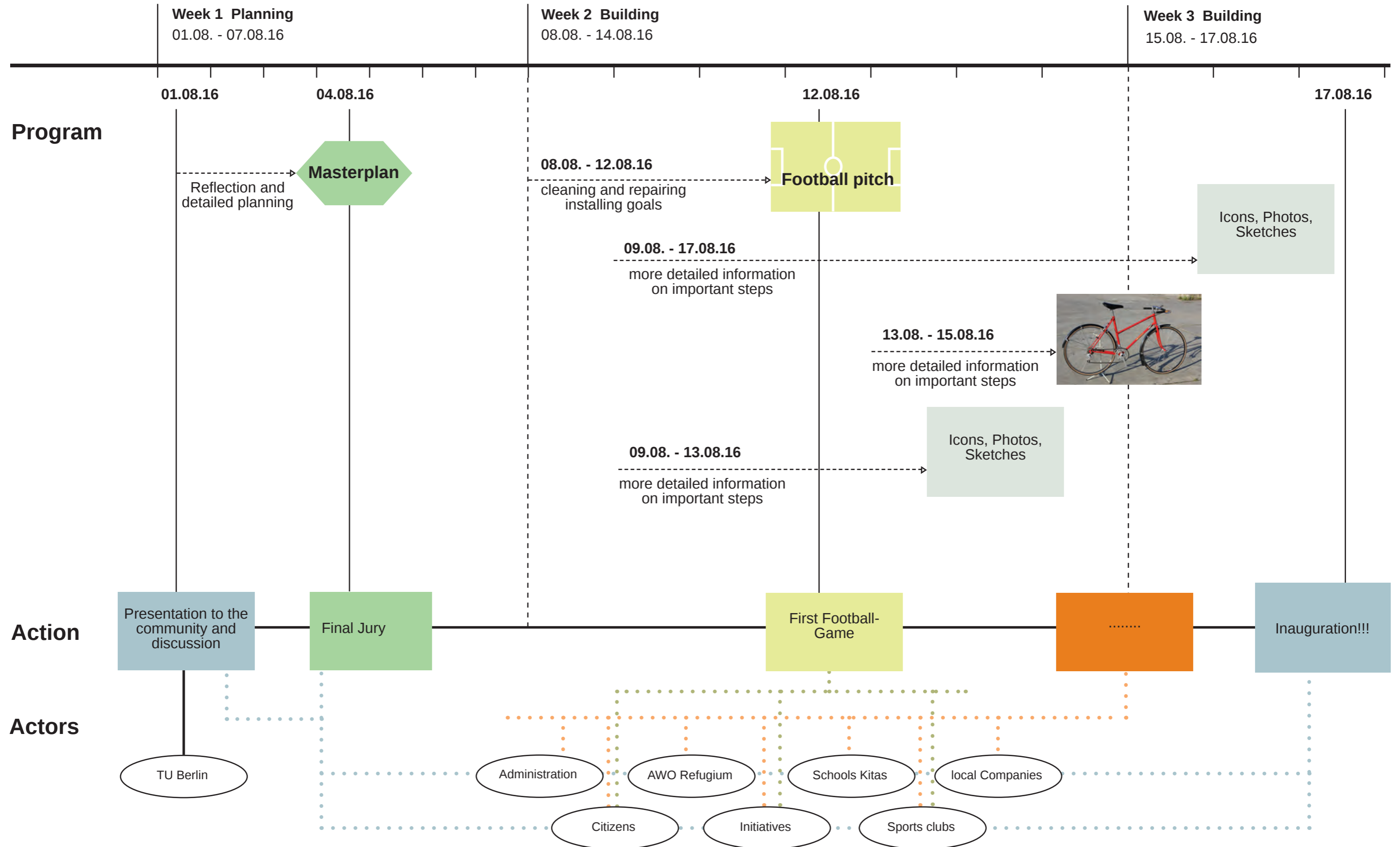

Green Ampitheatre

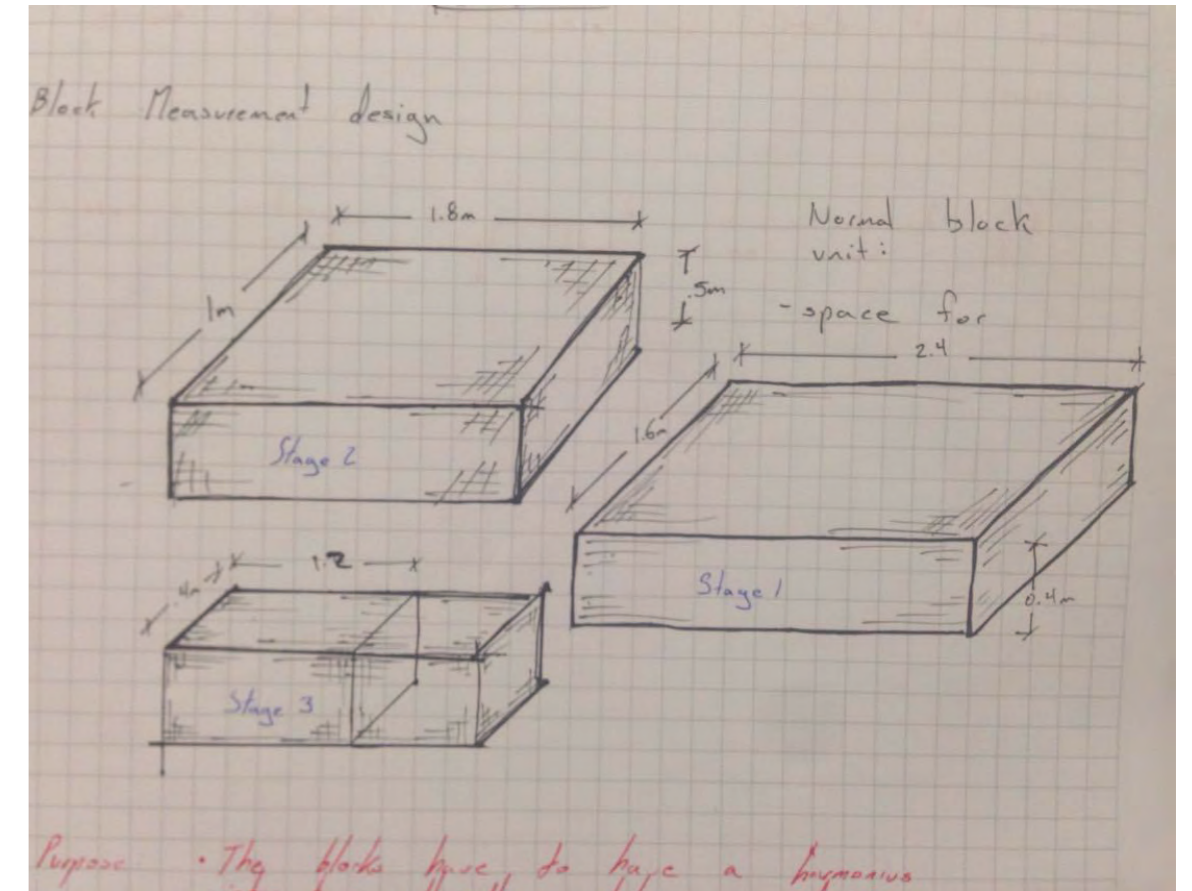
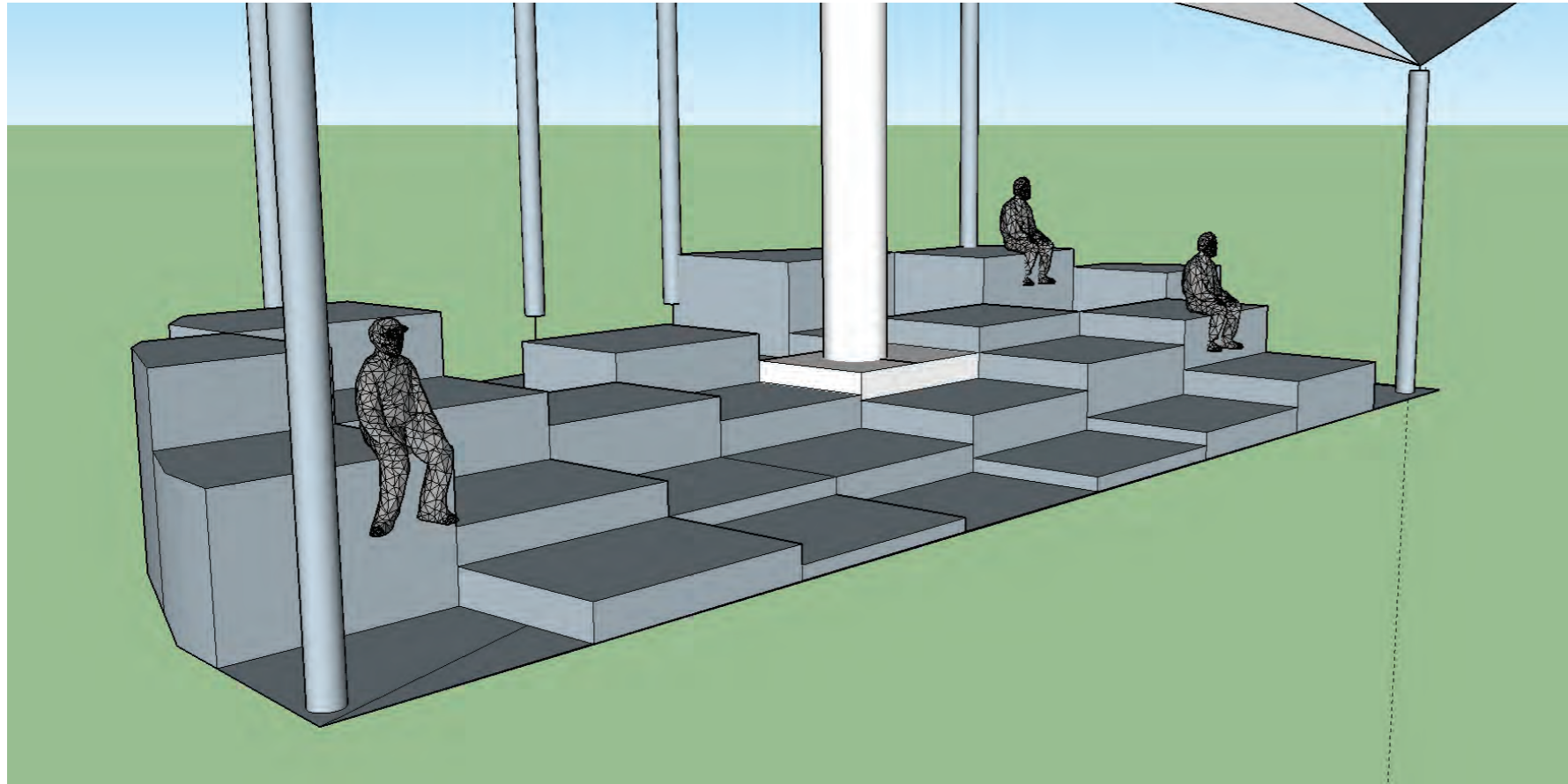

Ampitheatre-like blocks raised at different heights, aim to have a harmonious interaction with the surrounding vegetation. Placed beneath the existing vegetation it allows shading, human co-existence with nature and a space for activities of diverse types.

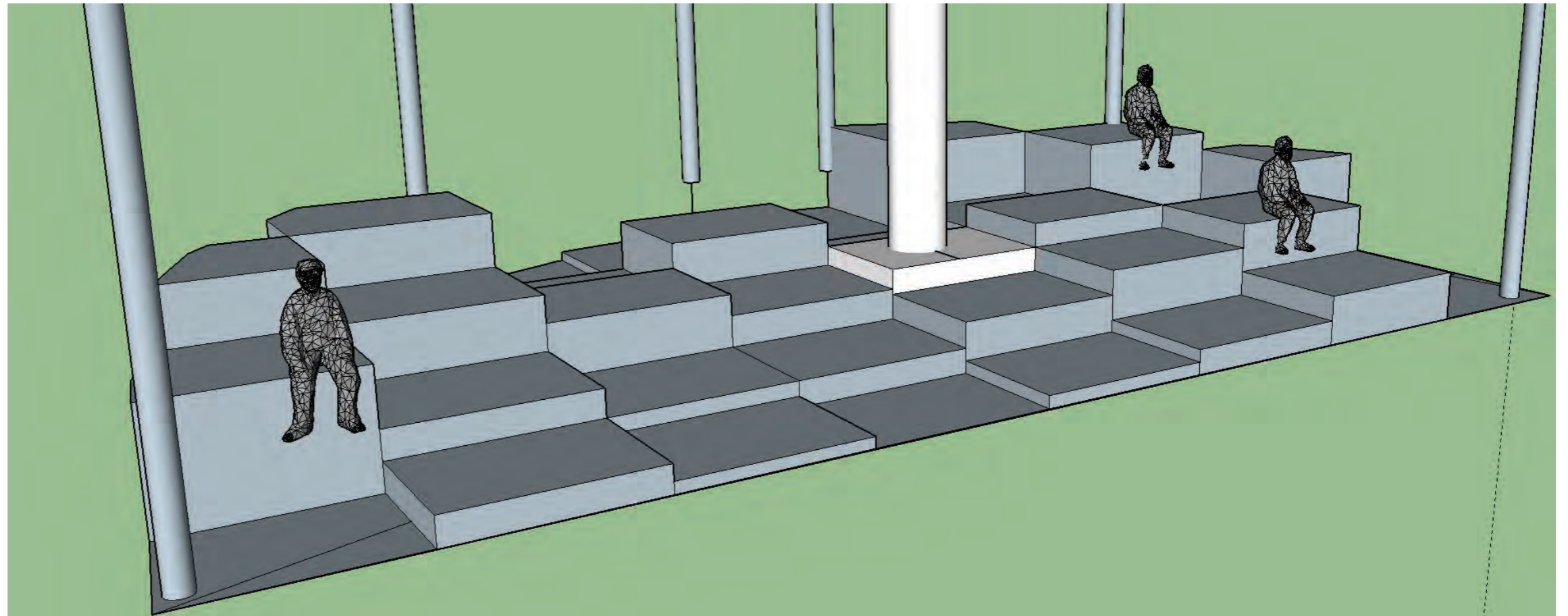

Movable Furniture Proposals

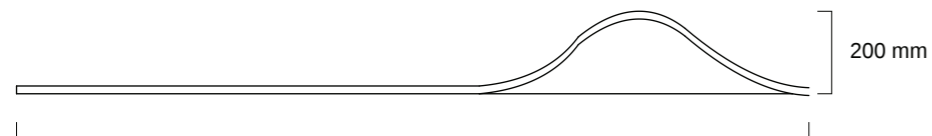
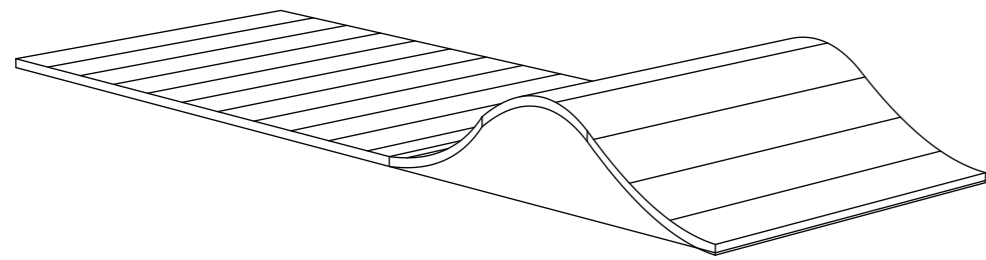
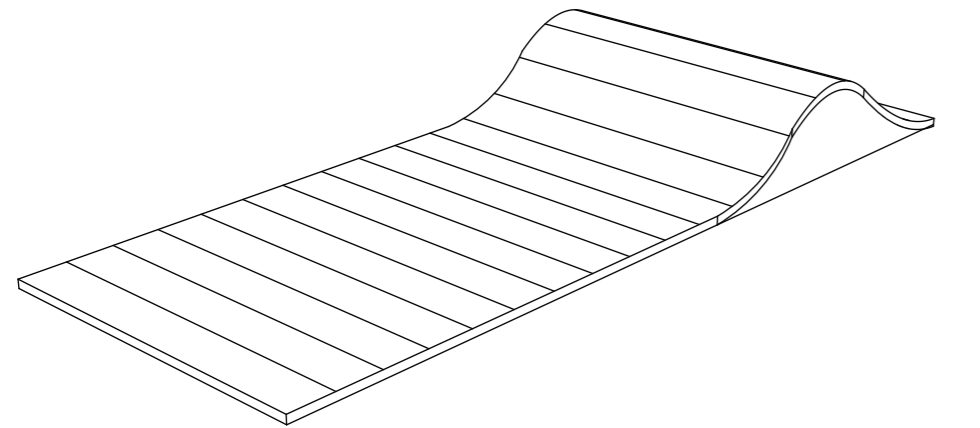

2000 mm

200 mm

'Flying Carpets':

Movable wooden carpet-like furniture, flexible to the different needs of the space. These allow a comfortable, simple raised seating for different events.

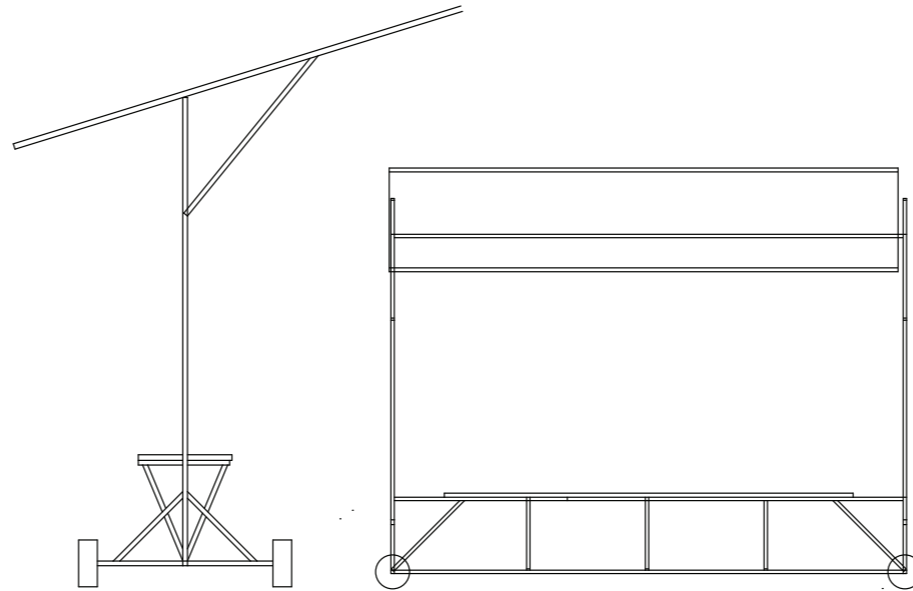
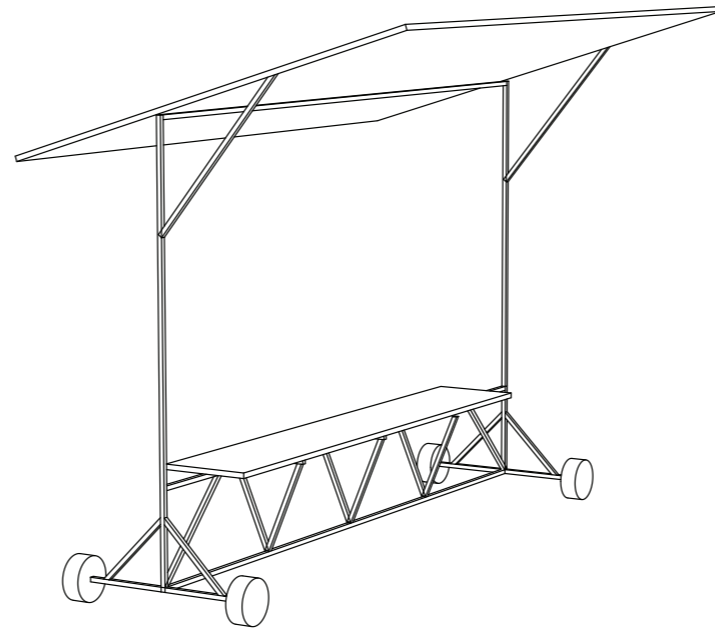

Movable Shades:

Lightweight, simple seating and shading which can be used as support in sport, bbq and educational events events.

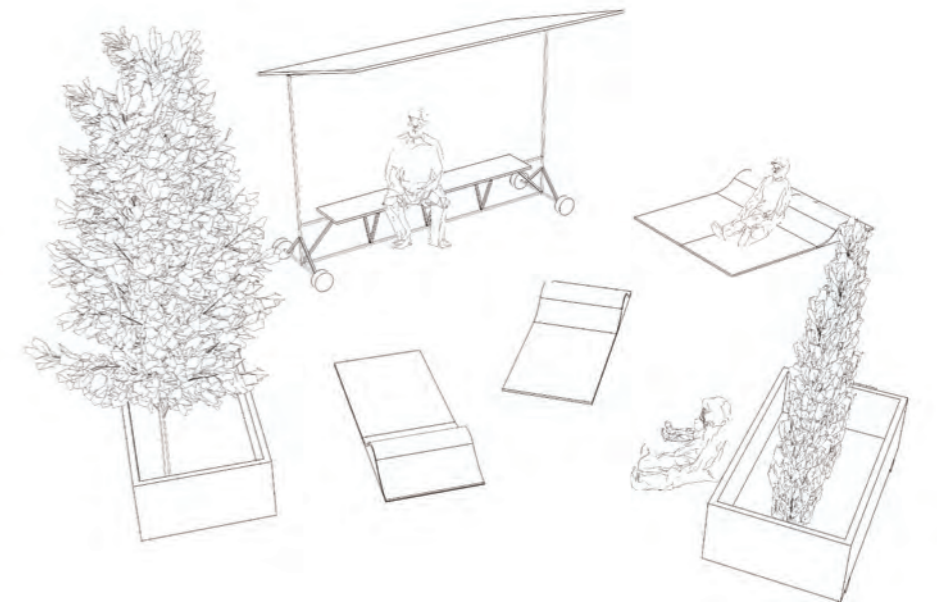
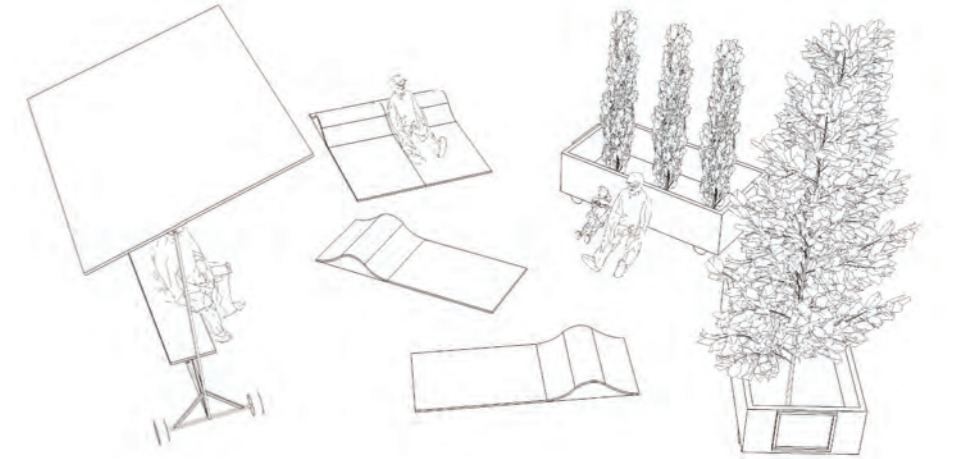

Brick BBQ:

Australian brick-style fixed BBQ which also allows space for interaction when sports is not involved.